

RICHMOND VALLEY LOCAL ENVIRONMENTAL
PLAN 2012 MAPPING

CADASTRE SITE BOUNDARY

LAND ZONE

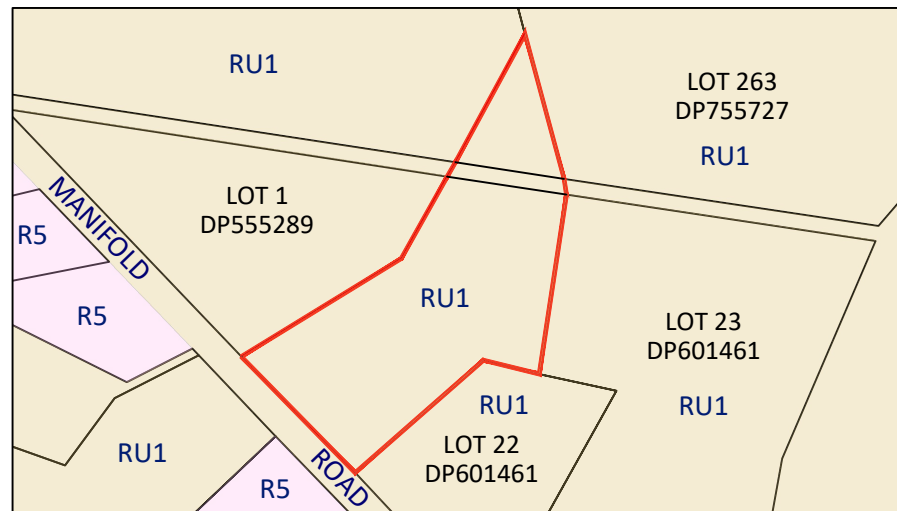

EXISTING LAND ZONING MAP

RU1 Primary Production **R5** Large Lot Residential

MINIMUM LOT SIZE

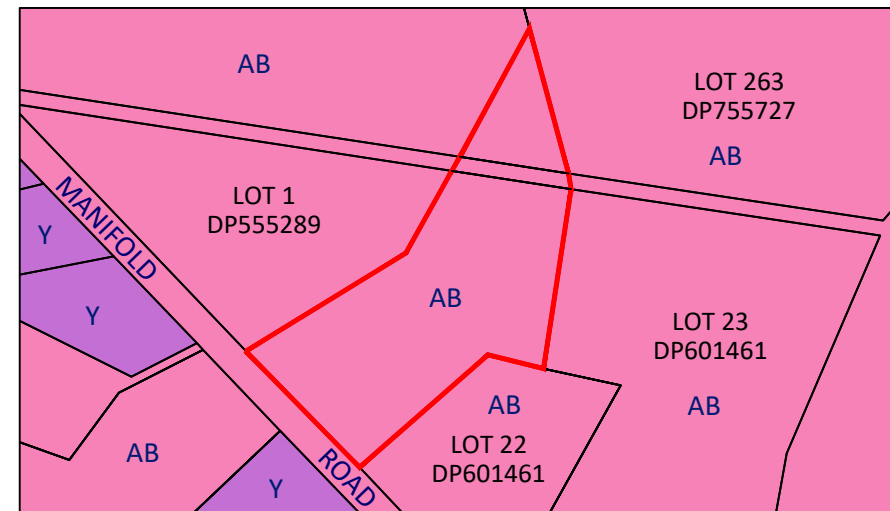

EXISTING MINIMUM LOT SIZE MAP

Y 1ha **AB** 40ha

DWELLING OPPORTUNITY

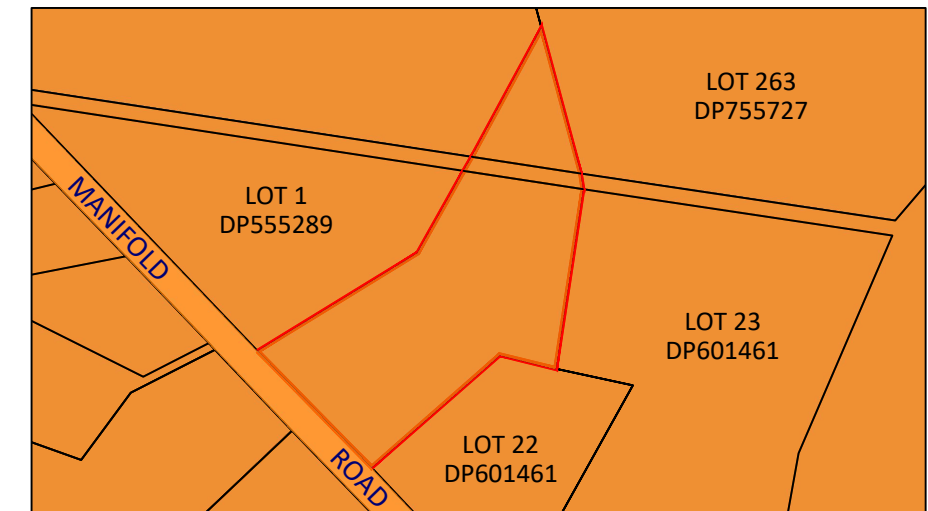

EXISTING DWELLING OPPORTUNITY

Dwelling Opportunity

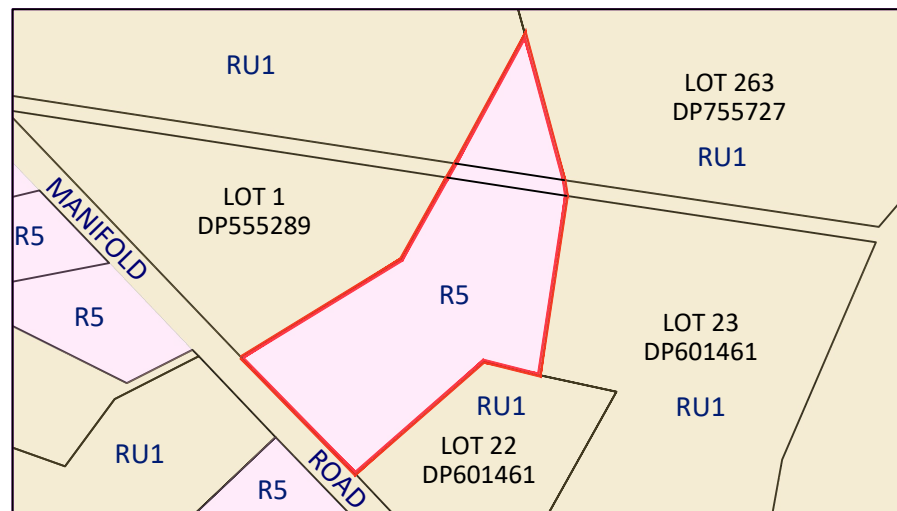

PROPOSED LAND ZONING MAP

RU1 Primary Production **R5** Large Lot Residential

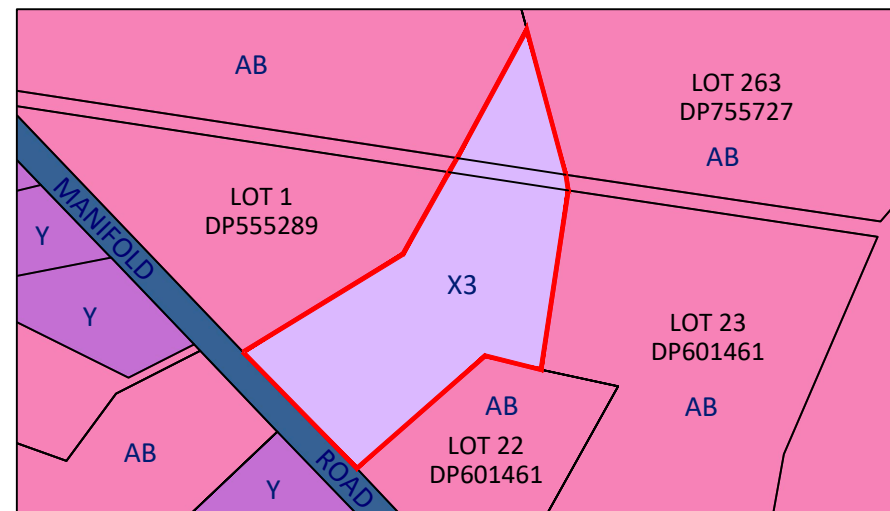

PROPOSED MINIMUM LOT SIZE MAP

X3 7500m² **Y** 1ha **AB** 40ha

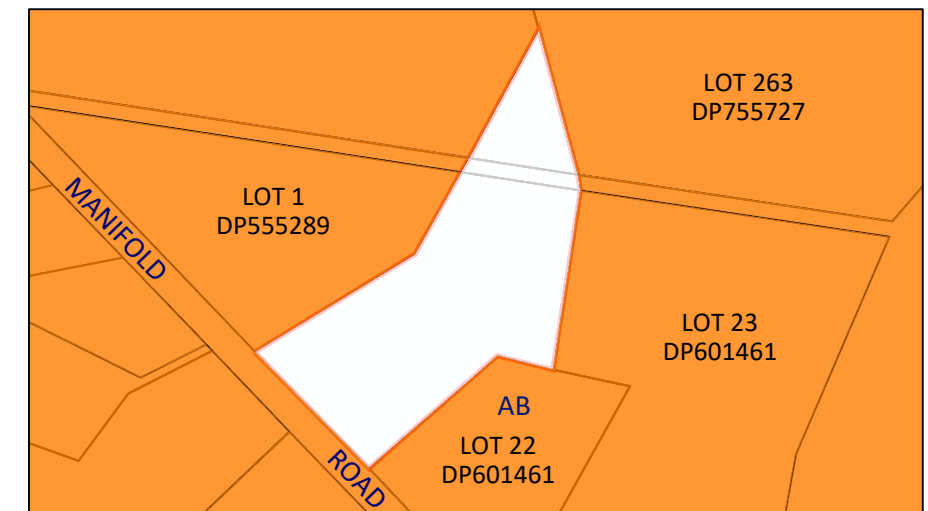

PROPOSED DWELLING OPPORTUNITY

Dwelling Opportunity

NOTE:

This preliminary layout has been completed in accordance with the instructions provided by Jestermond Pty Ltd. In this respect preliminary desktop data has been used to form this layout. The final layout is subject to the completion of a detailed survey & engineering plans. Accordingly, the conclusions reached within this report may be modified by the author upon the completion of the final design plans & site inspection. Newton Denny Chapelle accepts no responsibility for any loss or damage suffered, however so arising, to any person or corporation who may use or rely on this report.

REV	DATE	AMENDMENT
A	13.05.21	
B	18.05.21	BOUNDARY AMEND
C	27.07.22	LEP MAPPING PLAN ADDED TO SET
D	19.03.24	LEP MAPPING PLAN UPDATED
E	16.10.24	DWELLING OPPORTUNITY MAP ADDED

SOURCE PLAN: www.maps.six.nsw.gov.au - accessed 13.05.21

k:\jobs\2021\210336 - dougherty\planning\planning plans\ndc plans\cad files\210336-01-da-pl rev f - site analysis updated.dwg - plan 2 - lep mapping zone

NDC
Newton Denny Chapelle
Surveyors Planners Engineers
Email: office@ndc.com.au
31 Carrington St Lismore 2480
PH: 6622 1011
ABN: 18 094 689 845

PLAN 2: LEP MAPPING & LOT SIZE

CLIENT: Jestermond Pty Ltd

LOCATION: LOT 21 DP601461
70 MANIFOLD ROAD
NORTH CASINO NSW

DATE: 27.07.2022 REF: 210336-01-DA-PL_F
SCALE: 1 : 10000@A3 DRAWN: CD

© NEWTON DENNY CHAPELLE